

APA BUILD A BETTER HOME FOUNDATION DETAIL:  
**FULL-BASEMENT FOUNDATION WALL WITH GRANULAR DRAINAGE**

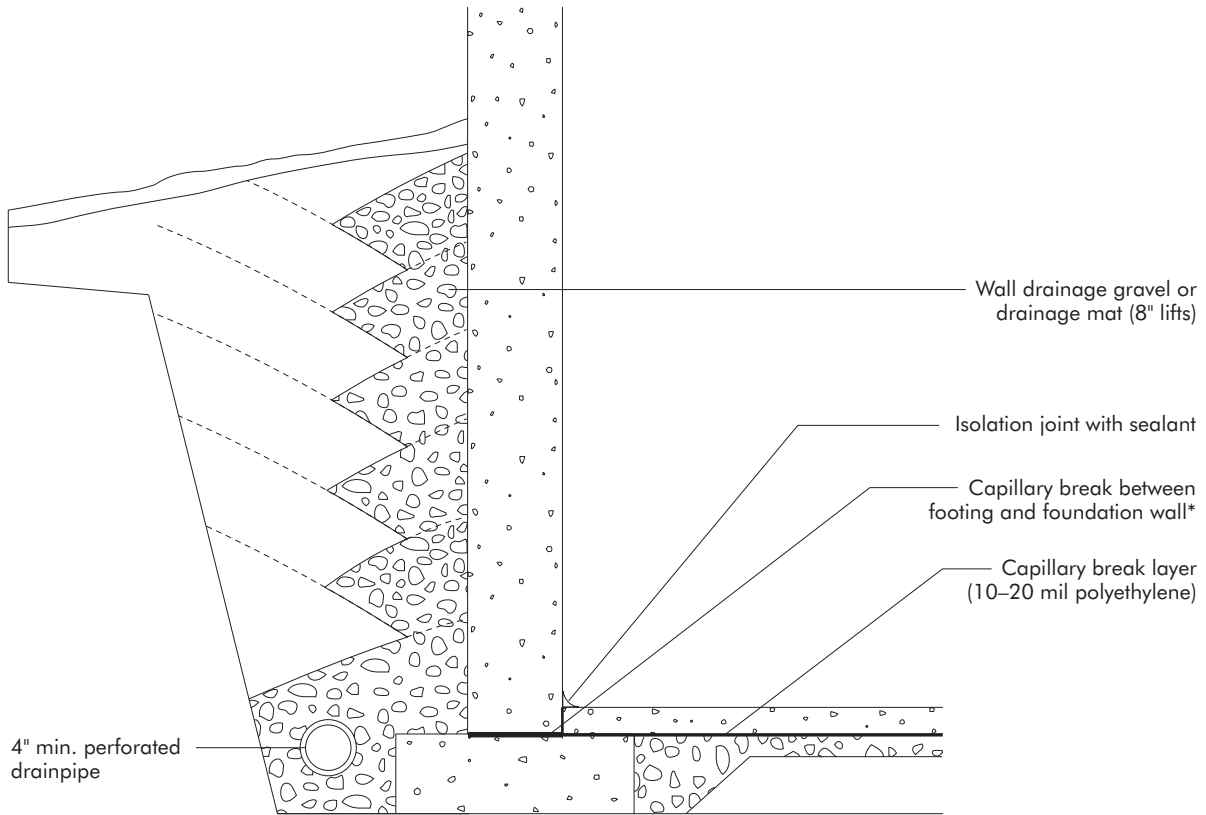

\*It is good practice to include a capillary break at the intersection of footing and basement wall to reduce the moisture content of the foundation wall. Neglecting this break may lead to capillary movement of water through the concrete, which may occur at high water table locations.